



College of Agricultural
and Life Sciences
Research Plots

Biocore
Prairie

Eagle Heights
Community
Gardens



Lake Mendota Dr

Lake Mendota Dr

Path

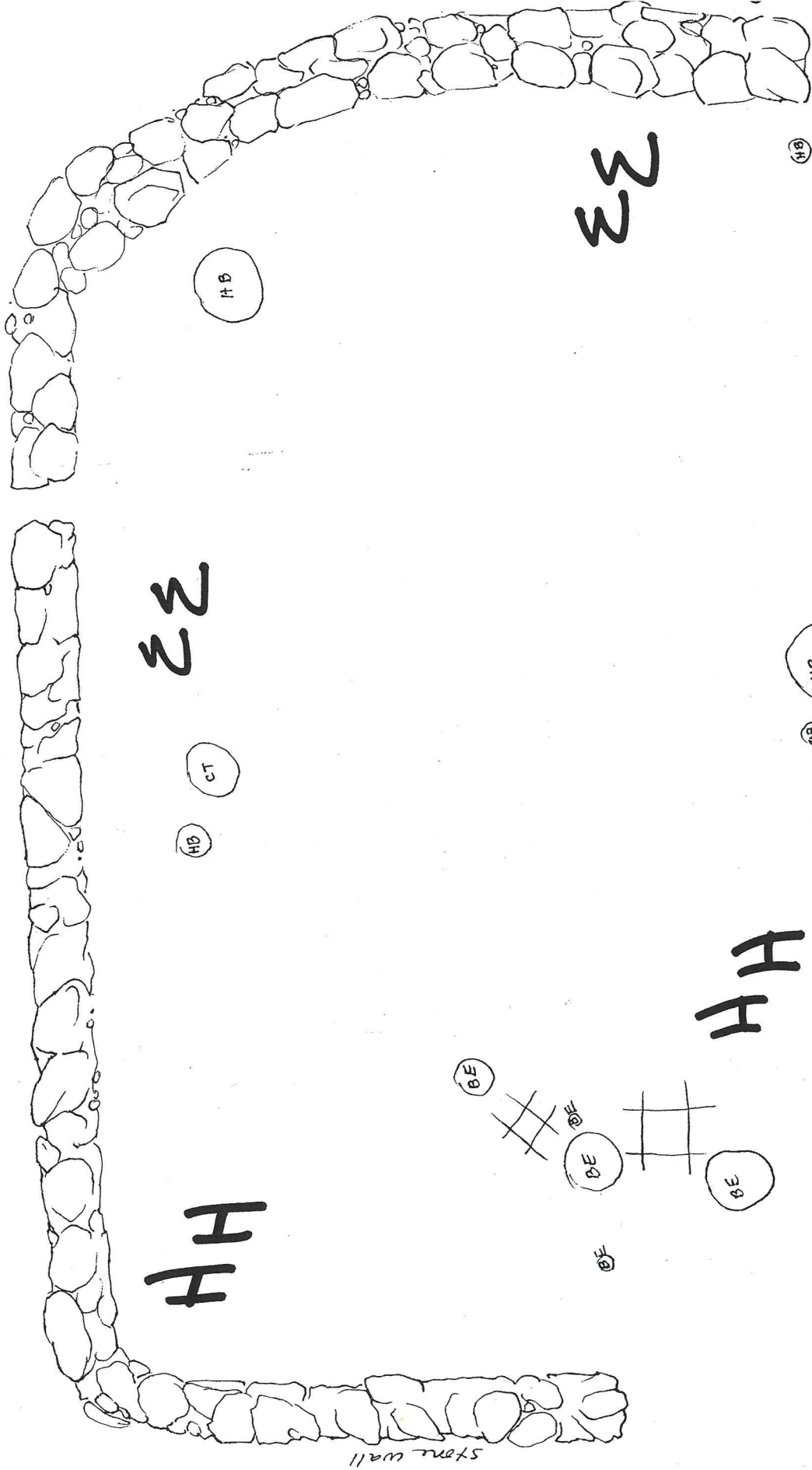

stone wall

90' x 50'

water line

N

HB - Hackberry tree
 CT - cherry tree
 BE - Boxelder
 HF - Wood pile

- [Spring Woodland Wildflowers](#)
- [Prairie Plants](#)
- [Wisconsin Sedges](#)
- [Naturalists Notes](#)
- [Arboretum Leaflets](#)
- [About](#)
 - [History](#)
 - [Mission and Vision](#)
 - [Plant Communities](#)
 - [Horticultural Collections](#)
 - [Visitor Center](#)
 - [Facility Use](#)
 - [Staff](#)
 - [Board of Visitors](#)
 - [Arboretum Committee](#)
 - [Employment](#)
 - [Contact Us](#)

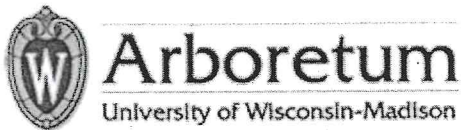

American Elm, White Elm

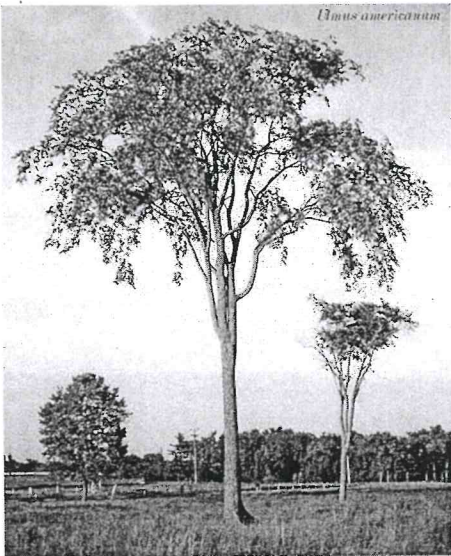

American Elm

Skip to:

- [Basic Plant Information](#)
- [Communities Plant Found In](#)
- [Leaves](#)
- [Flowers & Fruit](#)

- [Environmental Factors](#)
- [Planning & Planting Information](#)
- [Unique Features & Uses to Keep in Mind](#)

Woodland Plant Database

[Return to search results](#)

American Elm, White Elm

Basic plant information

- **Common Name(s):** American Elm, White Elm
- **Genus and Species:** Ulmus
- **Family:** Ulmaceae
- **Height:** large canopy = 75 to 100 feet or more (22.5 to 30 meters)
- **Longevity:** medium lived
- **Growth Rate:** medium
- **Form:** globular

[Back to top](#)

Communities plant found in

- Boreal Forest
- Northern Dry Forest
- Northern Dry Mesic Forest
- Northern Mesic Forest
- Northern Wet Mesic Forest
- Oak Barrens
- Oak Opening
- Southern Dry Forest
- Southern Dry Mesic Forest
- Southern Mesic Forest
- Southern Wet Forest
- Southern Wet Mesic Forest

[Back to top](#)

Leaves

- **Leaf Arrangement:** Alternate
- **Leaf Type:** Simple
- **Leaf Margin:** Toothed
- **Leaf Fall Color:** golden yellow

[Back to top](#)

Flowers & Fruit

- **Bloom Time:** early - mid April
- **Bloom Color:** red brown
- **Fruit Type:** circular wafer-like samara
- **Fruit Color:** tan brown
- **Fruit Time:** May

[Back to top](#)

Environmental Factors

- **Shade Tolerance:** Intermediate tolerance to shade
- **Soil Texture Range:** Moderately coarse to moderately fine
- **Drainage Range:** moderately poor to well drained
- **Moisture Range:** moist to dry
- **Reaction (pH):** 6.59999990463257
- **Sensitivity to Ice / Wind:** No
- **Sensitivity to Artificial Light:** Yes
- **Sensitivity to Salt:** Yes
- **Sensitivity to Soil Compaction:** Yes
- **Sensitivity to Heat / Drought:** No

[Back to top](#)

Planning & Planting Information

- **Root Pattern:** shallow to deep laterals, varies with site
- **Availability:** Yes
- **Associated Trees and Groundlayer Species:**
 - [Green Ash, Red Ash](#)
 - [Cottonwood](#)
 - [Box Elder, Ash-leaved Maple](#)
 - [Silver Maple, Soft Maple](#)
 - [Red Mulberry, Mulberry](#)
 - [Black Walnut, American Walnut](#)
 - [Hackberry, Sugarberry](#)
 - [White Ash, American Ash](#)
 - [Butternut, White Walnut](#)
 - [Bitternut Hickory, Swamp Hickory](#)
 - [Basswood, Linden](#)
- **Community Importance:**

Community	IV	Constancy
Boreal Forest	0.5	18
Northern Dry Forest	0.3	7

Northern Dry Mesic Forest	2	16
Northern Mesic Forest	6.6	37
Northern Wet Mesic Forest	16.3	40
Oak Barrens	0.8	7.1
Oak Opening	0.2	6.2
Southern Dry Forest	3.7	24
Southern Dry Mesic Forest	4	30
Southern Mesic Forest	5	40.4
Southern Wet Forest	26.5	66.7
Southern Wet Mesic Forest	73.7	90

[Back to top](#)

Unique Features & Uses to Keep in Mind

- **Wildlife Issues:** intermediate; songbirds, upland ground birds, waterfowl, small mammals
- **Human Uses:** ornamental; wood used for furniture, boxes, crates
- **Interesting Fact:** devastated by Dutch Elm disease; wood is heavy and difficult to split

[Back to top](#)

[Top](#)

[Skip Navigation Text](#)

- [Home](#)
- [Visit](#)
- [Volunteer](#)
- [Donate](#)
- [Shop](#)
- [Friends](#)
- [Education](#)
- [Land Care](#)
- [Research](#)
- [Publications](#)
- [About](#)
- [Contact](#)

© 2004–2011 University of Wisconsin-Madison Arboretum. All rights reserved. If you have questions about the site or trouble accessing some information, please contact the Webmaster: webmaster@uwarboretum.org.

- [Spring Woodland Wildflowers](#)
- [Prairie Plants](#)
- [Wisconsin Sedges](#)
- [Naturalists Notes](#)
- [Arboretum Leaflets](#)
- [About](#)
 - [History](#)
 - [Mission and Vision](#)
 - [Plant Communities](#)
 - [Horticultural Collections](#)
 - [Visitor Center](#)
 - [Facility Use](#)
 - [Staff](#)
 - [Board of Visitors](#)
 - [Arboretum Committee](#)
 - [Employment](#)
 - [Contact Us](#)



Arboretum
University of Wisconsin-Madison

Shagbark Hickory, Shellbark Hickory

Skip to:

- [Basic Plant Information](#)
- [Communities Plant Found In](#)
- [Leaves](#)
- [Flowers & Fruit](#)
- [Environmental Factors](#)
- [Planning & Planting Information](#)
- [Unique Features & Uses to Keep in Mind](#)

Woodland Plant Database

[Return to search results](#)

Shagbark Hickory, Shellbark Hickory

Basic plant information

- **Common Name(s):** Shagbark Hickory, Shellbark Hickory
- **Genus and Species:** *Carya*
- **Family:** Juglandaceae
- **Height:** large canopy = 75 to 100 feet or more (22.5 to 30 meters)

- **Longevity:** long lived
- **Growth Rate:** slow
- **Form:** irregular-ovoid

[Back to top](#)

Communities plant found in

- Cedar Glade
- Northern Dry Forest
- Northern Mesic Forest
- Oak Barrens
- Oak Opening
- Southern Dry Forest
- Southern Dry Mesic Forest
- Southern Mesic Forest
- Southern Wet Forest
- Southern Wet Mesic Forest

[Back to top](#)

Leaves

- **Leaf Arrangement:** Alternate
- **Leaf Type:** Compound pinnate
- **Leaf Margin:** Toothed
- **Leaf Fall Color:** golden yellow brown

[Back to top](#)

Flowers & Fruit

- **Bloom Time:** mid May
- **Bloom Color:** yellow green
- **Fruit Type:** globular nut in thick 4 parted husk
- **Fruit Color:** brown
- **Fruit Time:** early September - mid October

[Back to top](#)

Environmental Factors

- **Shade Tolerance:** Intermediate tolerance to shade
- **Soil Texture Range:** Medium to fine
- **Drainage Range:** moderately poor to well drained
- **Moisture Range:** wet to droughty
- **Reaction (pH):** 6.09999990463257
- **Sensitivity to Ice / Wind:** No
- **Sensitivity to Artificial Light:** No

- **Sensitivity to Salt:** Yes
- **Sensitivity to Soil Compaction:** No
- **Sensitivity to Heat / Drought:** No

[Back to top](#)

Planning & Planting Information

- **Root Pattern:** deep taproot
- **Availability:** Yes
- **Associated Trees and Groundlayer Species:**
 - [White Oak](#)
 - [Black Oak](#)
 - [Bur Oak, Mossy Cup](#)
 - [Black Cherry, Wild Black Cherry](#)
 - [White Ash, American Ash](#)
 - [Basswood, Linden](#)
 - [Bitternut Hickory, Swamp Hickory](#)
- **Community Importance:**

Community	IV	Constancy
Cedar Glade	0	0
Northern Dry Forest	0.3	2
Northern Mesic Forest	0.1	1
Oak Barrens	5.8	21.4
Oak Opening	19.9	56.3
Southern Dry Forest	8.2	53
Southern Dry Mesic Forest	8.5	49
Southern Mesic Forest	1.8	19.1
Southern Wet Forest	0.2	3.7
Southern Wet Mesic Forest	5.1	14.8

[Back to top](#)

Unique Features & Uses to Keep in Mind

- **Wildlife Issues:** intermediate; songbirds, small mammals
- **Human Uses:** edible nuts; fresh young shoots steamed and vapor inhaled for headaches
- **Interesting Fact:** best of all woods for smoking meats

[Back to top](#)

[Top](#)

Skip Navigation Text

- [Home](#)
- [Visit](#)
- [Volunteer](#)
- [Donate](#)
- [Shop](#)
- [Friends](#)
- [Education](#)
- [Land Care](#)
- [Research](#)
- [Publications](#)
- [About](#)
- [Contact](#)

© 2004–2011 University of Wisconsin-Madison Arboretum. All rights reserved. If you have questions about the site or trouble accessing some information, please contact the Webmaster: webmaster@uwarboretum.org.